

# TYPICAL COMPONENTS

QTY	QTY	QTY	QTY	QTY	QTY
MIN.	MAX.	MIN.	MAX.	MIN.	MAX.
120	361	300	T300 1-43	PSTB 370-600-710	T250P S1 I
150	414	360	T360 1-43	PSTB 470-600-710	T250P S1 I
150	477	400	T400 1-43	PSTB 470-600-710	T250P S1 I

NOTES:  
TYPICAL COMPONENTS BASED ON 480 V  
AND 75 V CONTROL VOLTAGE FOR  
MEDIUM AND LARGE CONTROL FACTORY.

DRAWING NUMBER  
D 2401 1420-021

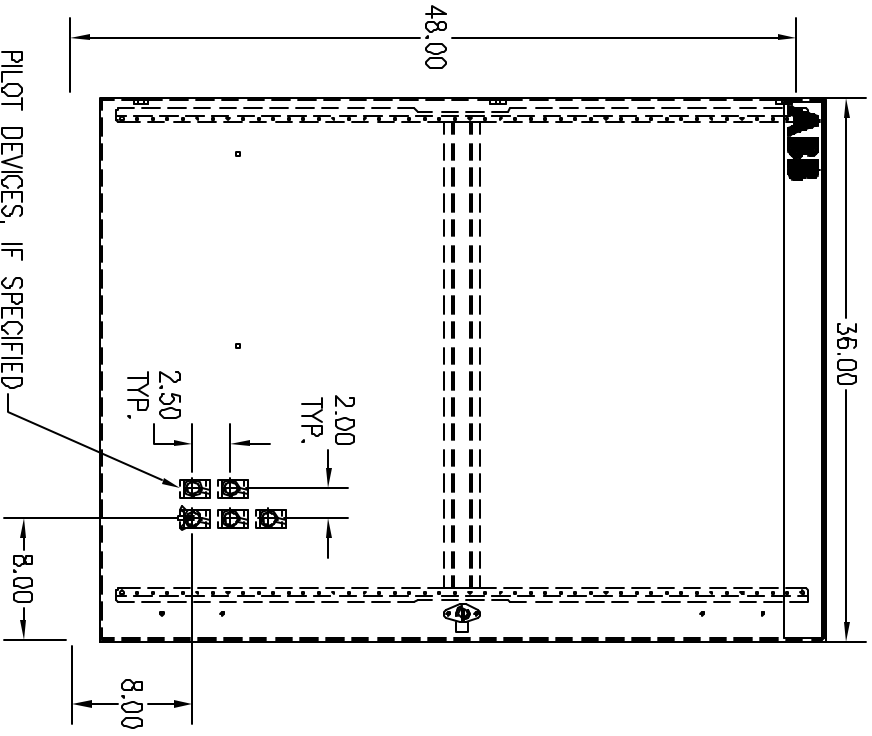

**FRONT VIEW**

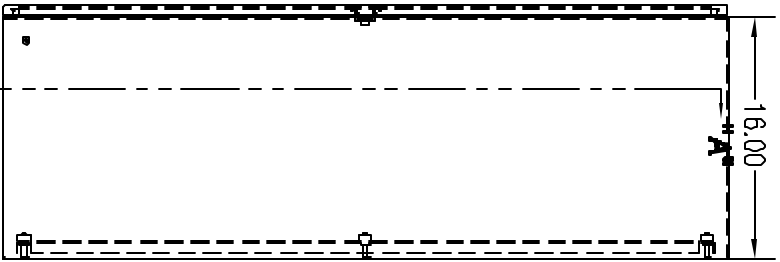

**SIDE VIEW**

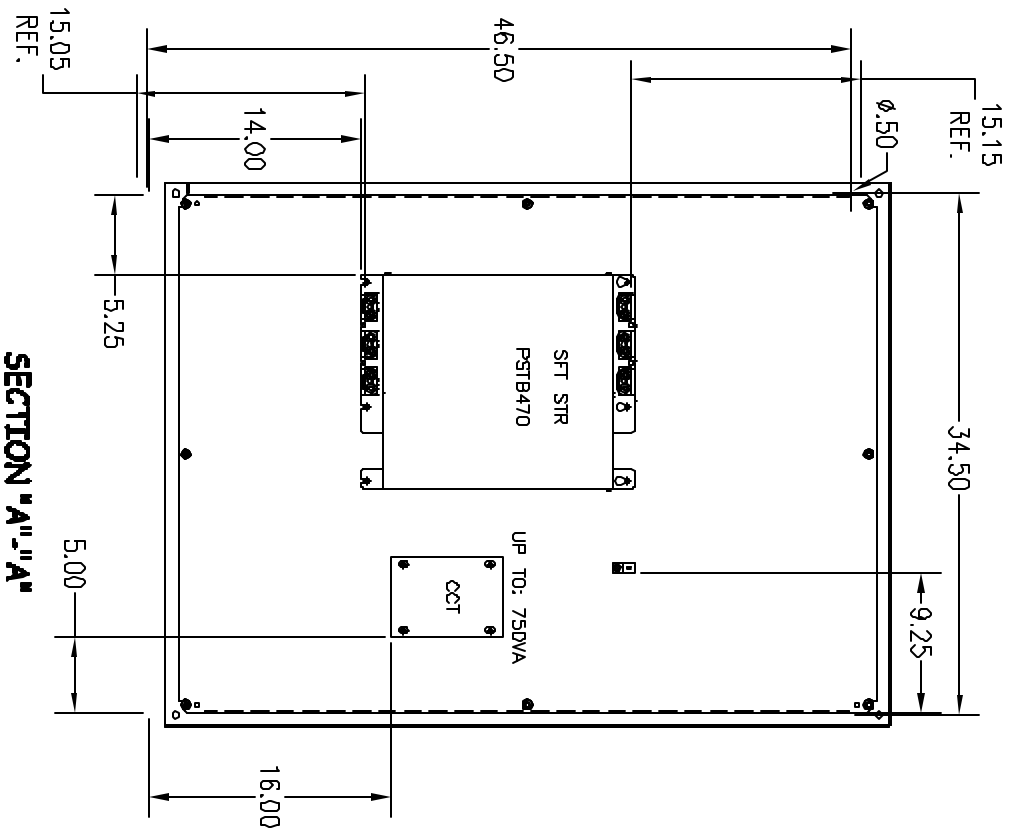

**SECTION "A-A"**

- 1) PLACE RUN LIGHT ABOVE DEVICE USED TO STOP MOTOR.
- 2) FOR MODELS EQUIPPED WITH HOA AND START-STOP, PLACE STOP TO LEFT OF HOA, PLACE RUN LIGHT ABOVE HOA IF REQUIRED.

DO NOT SCALE DRAWING

SCALE 5/64 DIMENSIONS ARE IN

Material: 48 X 36 X 16 N4.12  
C-SD483816

DATE 9/23/03

REV OR APPD BY

±.030 ±.030 ±.1"

STANDARD TOLERANCES ANGLES

THIS DRAWING IS THE PROPERTY OF ABB INC. INFORMATION WHICH MUST NOT BE REPRODUCED OR DISCLOSED TO OTHER THAN EXPRESSLY AUTHORIZED BY ABB INC.



ABB Inc.

DATE 9/24/03

DRAWN NUH

CHK'D

APP'D

PAGE 1 OF 1

REV. C

TITLE PNL L/O PSTB370-470  
INT BYP,N1,12,4,3R

SIZE DRAWING NUMBER

A D 2401 1420-021

SHOP

REV.	DESCRIPTION	DATE	BY	APP'D
B	CORRECTED PILOT DIMS	10/12/04	NUH	
C	ADD COMPONENT TABLE	9/23/03	NUH	
	ADDITIONAL REVISIONS			